

Scale: 40 pr. to an Inch.

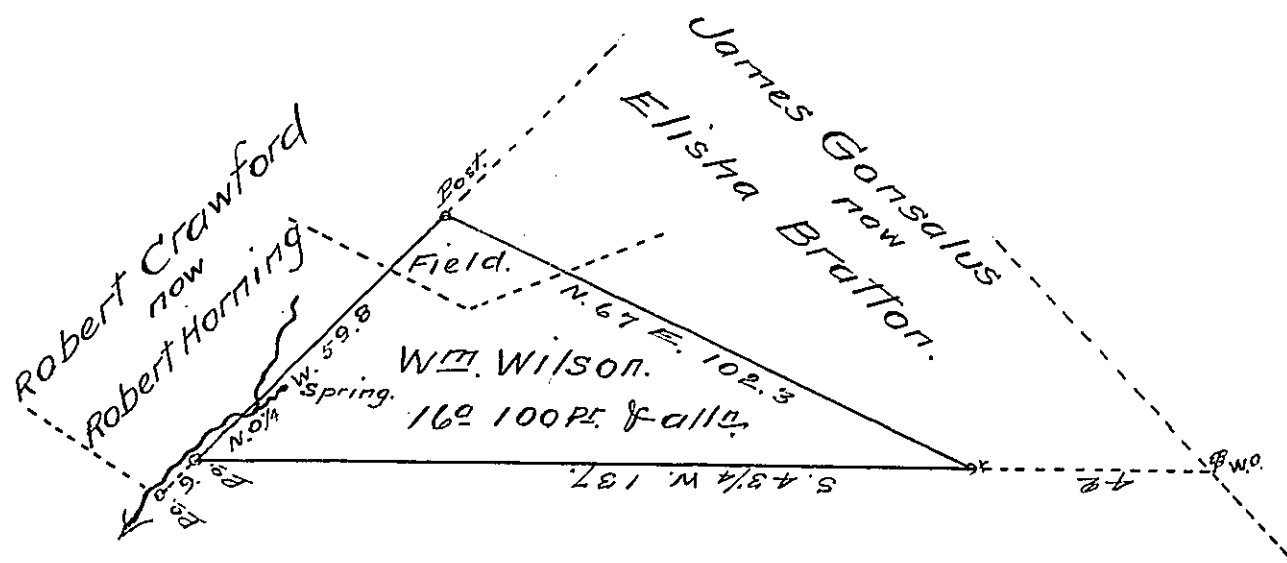

Christopher Seely now William Wilson.

A Draught of 169 100 perches of land with allowance of 6 per Cent for Roads &c. Situate in Oliver Township - Mifflin County Penna. Surveyed June 20th 1856 in pursuance of a Warrant to William Wilson for 209 dated May 19th 1856 - A field is cleared over the line N. 0 1/4 W. and the line N. 67 E. say 1 1/2 acres in Rye at the time of Survey - The time it was cleared not ascertained - say 10 or 12 years since.

John Swartzell C.S.

To J. Porter Brawley Esq.
Surveyor General of Penna.

IN TESTIMONY that the above is a copy of the original remaining on file in the Department of Internal Affairs of Pennsylvania, made conformably to an Act of Assembly approved the 16th day of February, 1833, I have hereunto set my Hand and caused the Seal of said Department to be affixed at Harrisburg, this twelfth day of September 1907.

Henry Howell
Secretary of Internal Affairs.